

FORM No. 1.

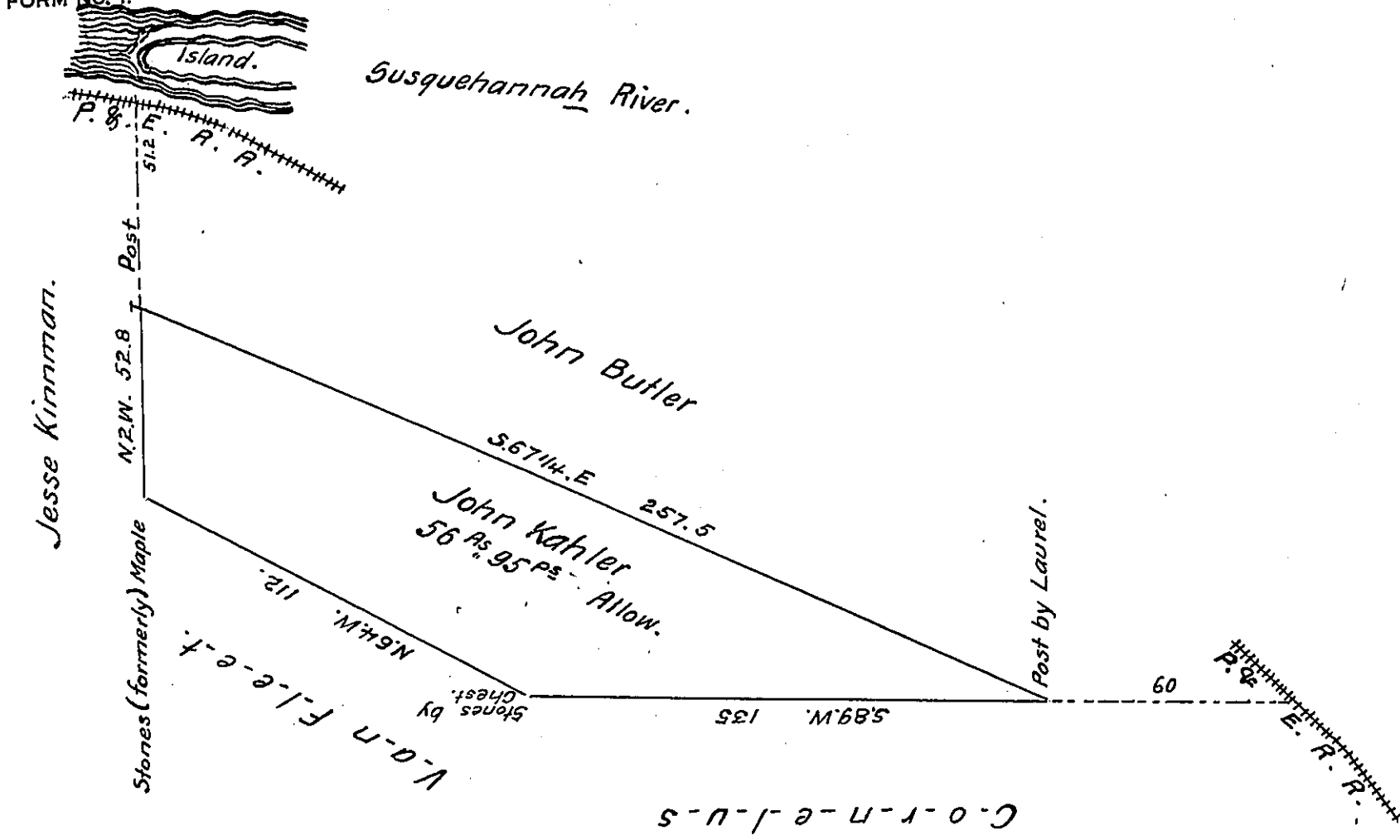

A Draft of a tract of land situated in the Township of Clinton in the County of Lycoming Containing Fifty Six Acres Ninety five perches and allowance of Six per Cent for Roads &c. Surveyed the 22nd of January 1884 in pursuance of Warrant granted to John Kahler dated November 29th 1882.

Hon J. Simpson Africa
Secy. of Internal Affairs

J. S. Laird Co. Surveyor

IN TESTIMONY that the above is a copy of the original remaining on file in the Department of Internal Affairs of Pennsylvania, made conformably to an Act of Assembly approved the 16th day of February 1833, I have hereunto set my hand and caused the Seal of said Department to be affixed at Harrisburg, this teenth day of December 1907

Henry Howard
Secretary of Internal Affairs.